

# Kinghelm®

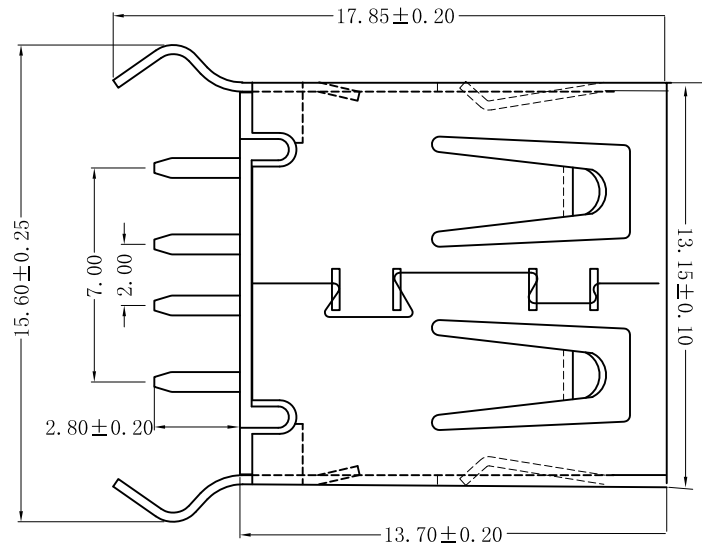
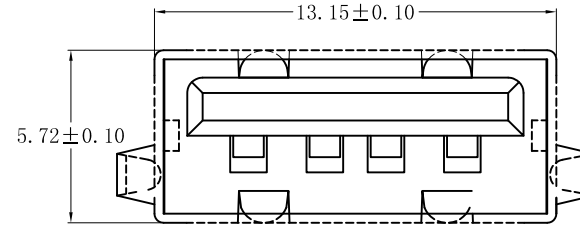
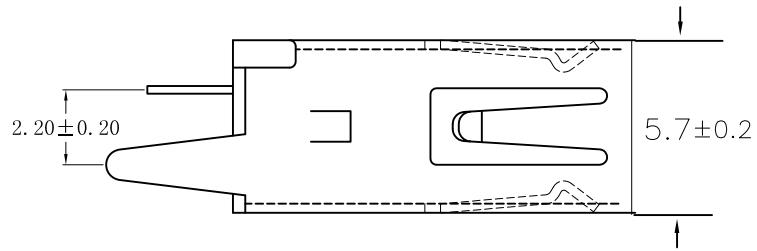

**Specifications:**

**Electrical:**

1. Current Rating: 1.5A/ contact terminal
2. Voltage Rating: 30V DC
3. Contact Resistance: 30 milliohms MAX
4. Dielectric Withstanding Voltage: 500 V AC AT Sea Level
5. Insulation Resistance: 1000MEGA ohms MIN

**Material:**

1. Housing: Hing Temperature Thermoplastics, PBT/LCP White/Black
  2. Contact: Copper Alloy C2680
  3. Shell: Copper Alloy C2680/SPCC
- Finish:**
1. Contact: Plated Gold in Mating Area; Tin On Solder Tails
  2. Shell: Nickel Plating

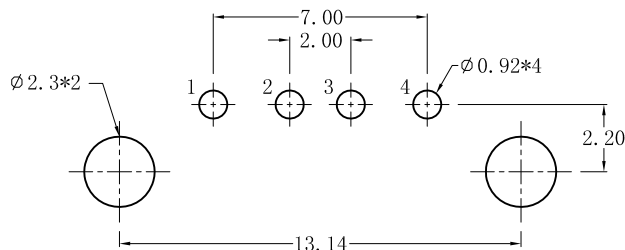

SHENZHEN KINGHELM ELECTRONIC CO., LTD.		WWW.BDS666.COM		DWG NO.	UNIT:MM
KH-AF180WJ-13.7		0755-83044319		REV	SCALE:1:1
PRODUCT NAME		DATE			
PART NO.		DESIGN		TOLERANCE UNSPECIFIED	
MODEL NO.		CHECKED		X.X ±0.30	
UB001G		APPROVED		X.XX ±0.20	
				X.XXX ±0.10	
				X° ±5°	
				X.X° ±2°	