

### SPECIFICATIONS

1. Current Rating: 7A AC, DC
2. Voltage Rating: 250V AC, DC
3. Temperature Range: -25°C~+85°C
4. Contact Resistance: 20mΩ Max
5. Insulation Resistance: 1000MΩ Min
6. Withstanding Voltage: 1500V AC/minute
7. Material: Wafer Nylon66, UL94V-0  
PIN Brass Tin-plated

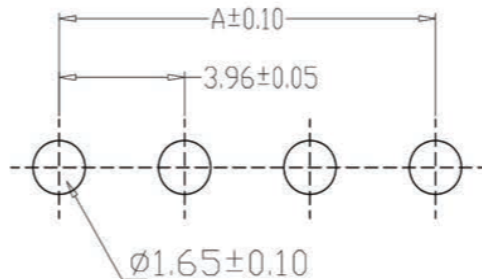
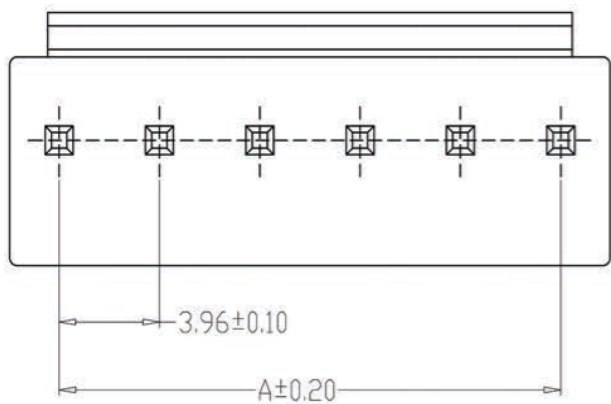

PCB LAYOUT

No.	Unit (mm)	
	A	B
A3961-02A	3.96	7.92
A3961-03A	7.92	11.88
A3961-04A	11.88	15.84
A3961-05A	15.84	19.80
A3961-06A	19.80	23.76
A3961-07A	23.76	27.72
A3961-08A	27.72	31.68
A3961-09A	31.68	35.64
A3961-10A	35.64	39.60
A3961-11A	39.60	43.56
A3961-12A	43.56	47.52

DRAWN	DESCRIPTION	DATE	GENERAL TOLERANCE		DRAWING	Qian Yuesheng 2013. 07. 01	PART NO.	A3961-NA		REV.	A
			X±0.25	X'±2'		Zhang Ming	TITLE	WAFER DIP TYPE		SHEET	1/1
			.X±0.20	.X'±1'	CHECK	2013. 07. 03	CUTM. NO.				
			.XX±0.15	.XX'±0.5'	APPROVAL	Zhang Ming 2013. 07. 05	SHENZHEN KINGHELM ELECTRONIC CO., LTD.		WWW. BDS666. COM		
			.XXX±0.10	.XXX'±0.5'	UNITS	MM	SCALE	1:1		KH-VH-7P-Z 0755-83044319	