

NOTES: 1.INSULATOR:HIGH-TEMP THERMOPLASTIC, U94V-0
COLOR:BLACK

2.CONTACT:COPPER ALLOY GOLD FLASH AND SOLDER AREA TIN
PLATING:CONTACT AREA OVERALL NICKEL UNDER PLATED
OR GOLD FLASH

ORDER INFORMATION: WB105-X XX X-04~07A4 X

PACKING: E:TUBE
R:PLASTIC REEL
L:PAPER REEL

TYPE

E:POST AND FITTING NAIL
L:POST
F:FITTING NAIL
N:NO POST AND FITTING NAIL

PIN

PLATING
E:TIN
F: GOLD FLASH

WB105:0.5 BOARD TO BOARD SMT V/T TYPE MALE
(HALOGEN FREE)

M/H	TYPE	H	J	K	L
3.5					
4.0					
5.0					
6.0					
7.0	04~A4	1.00	3.00	2.6	1.5
8.0					
9.0					
10.0					
11.0					
12.0					
13.0					
14.0					
15.0					
16.0					
17.0					
18.0					
19.5					
20.0					
21.5					
22.5					
24					
26					
28					
30					
32					
34					
36					
38					
40					
42					
44					
46					
48					
50					
52					
54					
56					
58					
60					
62					
64					
66					
68					
70					
80					

PIN NO.	A	B	C	D
10	2.0	5.0	4.0	2.5
12	2.5	5.5	4.5	3.0
14	3.0	6.0	5.0	3.5
16	3.5	6.5	5.5	4.0
18	4.0	7.0	6.0	4.5
20	4.5	7.5	6.5	5.0
22	5.0	8.0	7.0	5.5
24	5.5	8.5	7.5	6.0
26	6.0	9.0	8.0	6.5
28	6.5	9.5	8.5	7.0
30	7.0	10.0	9.0	7.5
32	7.5	10.5	9.5	8.0
34	8.0	11.0	10.0	8.5
36	8.5	11.5	10.5	9.0
38	9.0	12.0	11.0	9.5
40	9.5	12.5	11.5	10.0
42	10.0	13.0	12.0	10.5
44	10.5	13.5	12.5	11.0
46	11.0	14.0	13.0	11.5
48	11.5	14.5	13.5	12.0
50	12.0	15.0	14.0	12.5
52	12.5	15.5	14.5	13.0
54	13.0	16.0	15.0	13.5
56	13.5	16.5	15.5	14.0
58	14.0	17.0	16.0	14.5
60	14.5	17.5	16.5	15.0
62	15.0	18.0	17.0	15.5
64	15.5	18.5	17.5	16.0
66	16.0	19.0	18.0	16.5
68	16.5	19.5	18.5	17.0
70	17.0	20.0	19.0	17.5
80	19.5	22.5	21.5	20.0

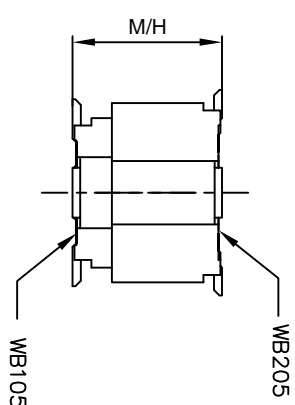

KH-WB105-F40E-04L

0755-83044319

SHENZHEN KINGHELM ELECTRONIC CO., LTD.

WWW.BDS666.COM

GENERAL TOLERANCE UNLESS OTHERWISE SPECIFIED	DRAWN	PART NO.
XX	Checked	WB105-XXXX-04~07.A4X
XXX	Checked	
XXXX	Checked	
ANG.	Checked	
±0.30'	Checked	
APPROVED		TITLE?
SHEET 1/1		0.5 BOARD TO BOARD SMT V/T TYPE MALE
UNIT	SCALE	SIZE
MM	5:1	A4
		REV
		A