

technical characteristics :
 Space: 1.5mm
 Rated Voltage: 50V AC,DC
 Rated Current: 0.5A AC,DC
 Contact Resistance: 0.04
 Insulation Resistance: 800
 Withstand Voltage: 200V AC/minute

Materials:
 Housing: PA9T UL94V-0 Natural Colour
 Contact Pins: Brass(Tin-plating)
 Soldering Terminal: Phosphor Bronze(Tin-plating)

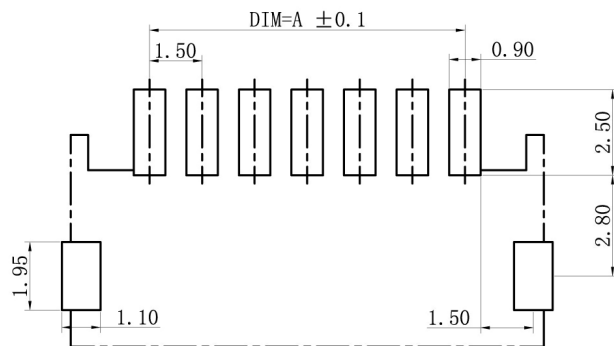

P. C. B LAYOUT REF

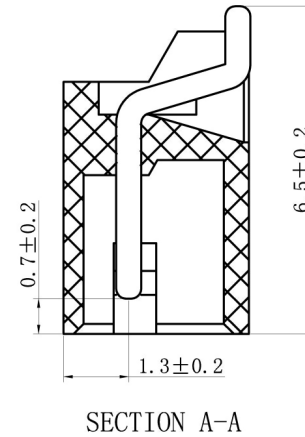
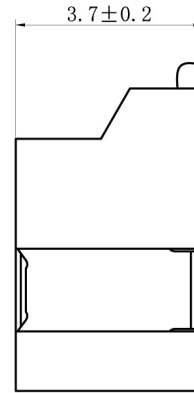
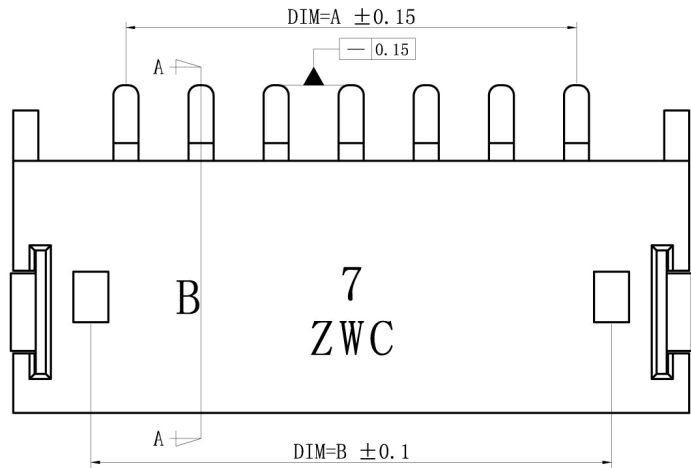

NO. of Contacts (n)	Dimensions		
	A	B	C
2	1.5	2.9	6.1
3	3.0	4.4	7.6
4	4.5	5.9	9.1
5	6.0	7.4	10.6
6	7.5	8.9	12.1
7	9.0	10.4	13.6
8	10.5	11.9	15.1
9	12.0	13.4	16.6
10	13.5	14.9	18.1
11	15.0	16.4	19.6
12	16.5	17.9	21.1
13	18.0	19.4	22.6
14	19.5	20.9	24.1
15	21.0	22.4	25.6
16	22.5	23.9	27.1
17	24.0	25.4	28.6
18	25.5	26.9	30.1
19	27.0	28.4	31.6
20	28.5	29.9	33.1

SER	AREA	REVISIONS	CHK	DATE

UNLESS OTHERWISE SPECIFIED TOLERANCES ARE
 X. ±0.2
 X.X ±0.1
 X.XX ±0.05
 ANG.
 X ±0.5
 X.X ±0.1

SHENZHEN KINGHELM ELECTRONIC CO., LTD.		WWW.BDS666.COM	
KH-ZH1.5WF-04A		0755-83044319	
CHECKED	DATE	APPROVED	DATE
DRAWN	DATE	DRAWING NO	
Zhou Jianfeng	2007/12/05	1.5TA-7P	
UNIT	SCALE	SIZE	REV
MM	5:1	A4	A