

Kinghelm®

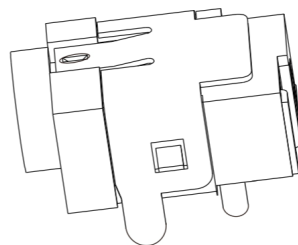
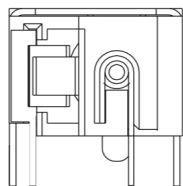
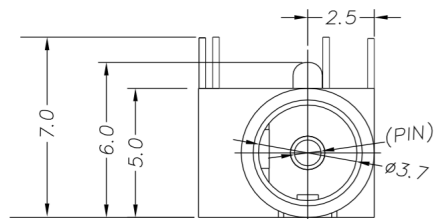

Correction (Marking)	Description	Date

Main Technical Properties		Tolerance
Rated Electrical Load	DC 30V/0.5A	X±0.20
Contact Resistance	≤0.02Ω	X±0.10
Insulation Resistance	≥100MΩ	XX±0.05
Withstand Voltage	AC500V(Hz)/min	XXX±0.02
Insertion-withdrawal Force	3-20N	X°±5°
Range of Operating Temperature	-30°C~70°C	X°±2°
Service Life	5000 times	XX°±1°

Opening Dimension of PCB

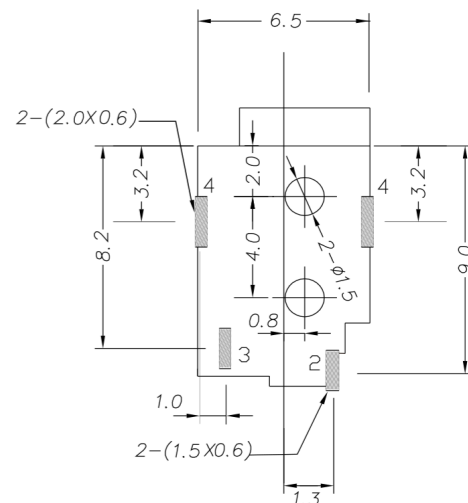
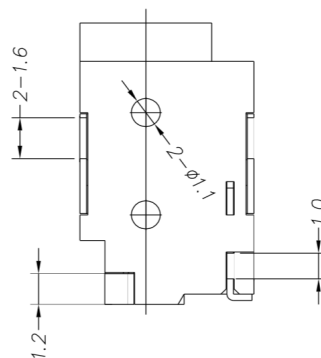
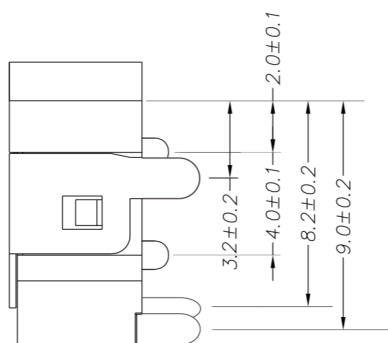
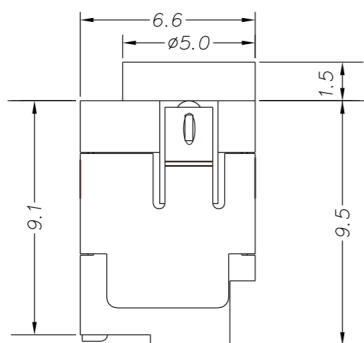

PIN	φ 1.0	φ 1.3
-----	-------	-------

No.	Item No	Product name	Quantity	Materials	SPECIFICATION	Plating	Schematic	Visual Angle	Designed	Department Countersignature	Product name: DCElectrical Socket	
7									Edition	Assembly Department		Stamping Department
6						Date			Injection Department	Marketing Department		
5						scale			Checked	Approved		
4	DC-031	Housing	1	H62Brass Strip	T=0.25	Silver-plating			4	2	3	Model: DC-031
3	DC-032	Flexible Piece	1	H63Brass Strip	T=0.25	Silver-plating						
2	DC-033	Center Pin	1	H64Brass Strip	T=0.25	Silver-plating	SHENZHEN KINGHELM ELECTRONIC CO., LTD.			6 sheets in total	Page4	
1	DC-034	Base	1	PPA	Black		KH-DC-031-1.3			www. BD5686. COM	Sheet Numbers	
										0755 - 83044319		