

PCB LAYOUT
S=2:1

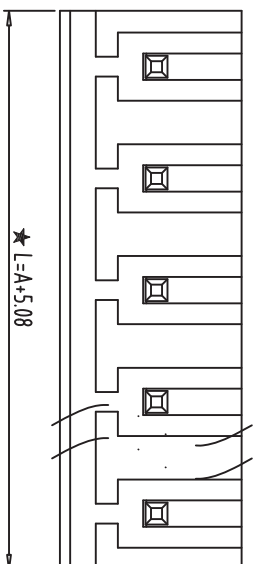

★ A=5.08x(P-1)

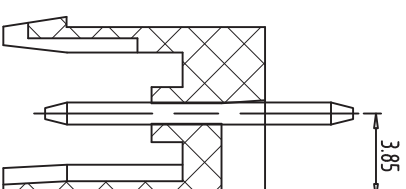
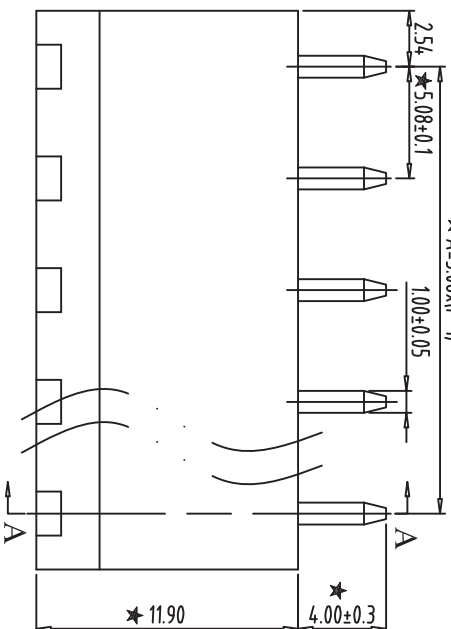

SECTION:A-A

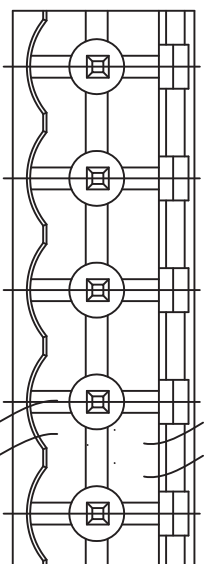
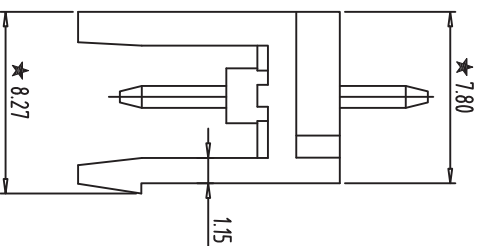

- NOTES:
1. Rating:300V 15A ;
 2. Insulation Withstands Voltage: AC2000V/MIN
 3. Insulation Resistance: 500MΩ or more at DC500V
 4. Using Temperature Range: -40°C~+105°C
 5. "★" is the important dimension
 6. RoHS compliance

Total Pitch Tolerances		Nominal dimension range																																																								
In mm		In mm																																																								
0	to	0	to	53	to	90	to	115	to	150	to	200	to	250	to	300	to	350	to	400	to	450	to	500	to	550	to	600	to	650	to	700	to	750	to	800	to	850	to	900	to	950	to	1000														
±0.18	to	±0.20	to	±0.25	to	±0.3	to	±0.35	to	±0.44	to	±0.50	to	±0.60	to	±0.70	to	±0.85	to	±1.00	to	±1.20	to	±1.50	to	±2.00	to	±2.50	to	±3.00	to	±3.50	to	±4.00	to	±4.50	to	±5.00	to	±5.50	to	±6.00	to	±6.50	to	±7.00	to	±7.50	to	±8.00	to	±8.50	to	±9.00	to	±9.50	to	±10.00

ITEM	NAME OF PART	NO. OF PART	Q'TY	MATERIAL	NOTE
DWG	SK	DATE	2014/08/19	SIZE	A4
CHK	DATE			SCALE	3:1
APP.	DATE			SCALE	2EDG-5.08

SHENZHEN KINGHELM ELECTRONIC CO., LTD		WWW. BDS666. COM	
KH-F400V-6P-5. 08G		0755-83044319	