

Kinghelm®

| REVISIONS | | | | | |
|-----------|--------|-------------|-----|-----|------|
| REV | NUMBER | DESCRIPTION | DWN | CHK | DATE |
| A | | DESIGN | | | |

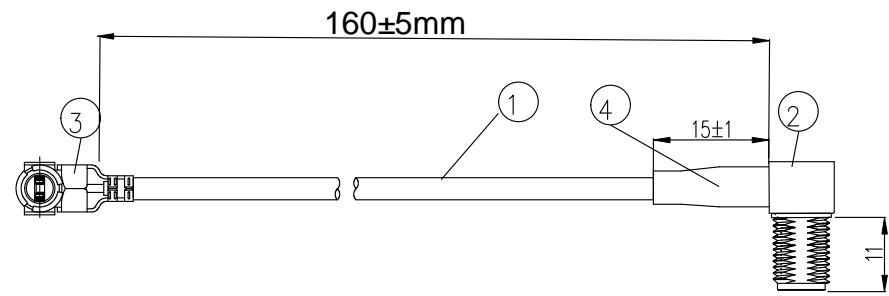

- NOTES:
- ELECTRICAL:
 - VOLTAGE RATING:DCV 100V 10MS
 - CONDUCTANCE RESISTANCE: 3.0 OHM/MAX.
 - INSULATION RESISTANCE: 20M OHM/MIN.
 - THE CABLE SHOULD BE 100% ELECTRICAL TEST
 - IT SHOULD BE NO ANY OPEN/SHORT, MISWIRING AND INTERMITTENT FAILURES.
 - MATERIAL:
 - SEE TABLE
 - ALL COMPONENTS ARE RoHS COMPLIANT.

| ITEM NO. | PART NUMBER | DESCRIPTION | QTY. |
|----------|-------------|-----------------------|------|
| ④ | 套管 | 黑色热缩套管, 2*15MM | AS |
| ③ | 接头 | 四代IPEX1.37国产端子 | 1 |
| ② | 接头 | SMA母头母针 弯头, 11牙, 镀金 | 1 |
| ① | 同轴线 | RF1.37黑色线, OD: 1.37mm | AS |

深圳市金航标电子有限公司 www.kinghelm.com.cn
 型号: KH-SMAKW-IPEX4-RG1.37-B160 0755-83044319

| | | | |
|----------------------------------|--|----------------------|-------------------------------|
| ALL DIMENSION ARE IN MM | DRAWN Jamy | DATE 2019 /03 /01 | I-PEX to SMA/F L=160MM |
| | ENG. | | |
| COMPUTER GENERATED IN SOLIDWORKS | MFG. | | |
| DO NOT SCALE THIS DRAWING | Q.A. | | |
| PROJECTION | GENERAL TOLERANCE FOR ANGLES X.X X.XX X.XXX ± 1' ± 0.3 ± 0.25 ± 0.150 | | SIZE B |
| CUSTOMER P/N: | | | REV A |
| | | SCALE: Free | TYPE |
| | | SHEET 1 OF 1 | |