

**Technical Specifications**

1. Rated Current: 50mA 12V DC
2. Contact Resistance: 100m
3. Actuation Force: 160 ± 30gf/260 ± 50gf
4. Travel: 0.15 ± 0.05mm
5. Insulation Resistance: 10M
6. Dielectric Strength: 100V 50Hz 1Min
7. Lifetime: 50,000 times

**Electrical Schematic Diagram**

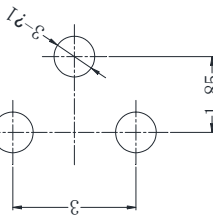
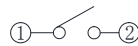

**PCB Diagram**

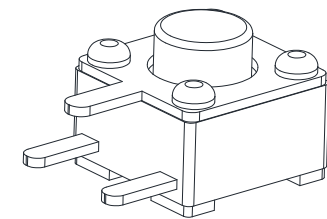

No.	Component	Material	Qty.	Note	Mark	Count	Changed file No.	Sig.	Date	First-person Perspective	Scale	Part No.	Product Name		
E	Cover	0.25 Iron Sheet	1	Tin-plated Copper						General Tolerance	1:1	4.5*4.5 Edge Tripod			
D	Plunger	Black PPA	1	Cleaning						>0.5-2	mm	4.5*4.5 Edge Tripod (2.0)			
C	Contact Dome	Stainless Steel Silver Plating	1							>2-5					
B	Base	Black PPA	1	Cleaning						>5					
A	Contact	0.3 Brass	1	Silver-plated						Angle					
											Designed	Checked	Approved	Shenzhen Kinghelm Electronics Co., Ltd	www.kinghelm.net
														KH-4.5X4.5X8.5H-SMT	0755-28190160