

Technical Parameters

1. Rated Current: 50mA 12V DC
2. Contact Resistance: 100 m
3. Actuation Force: 160+30gf/260+50gf
4. Travel: 0.15±0.05mm
5. Insulation Resistance: 100 M
6. Electrical Resistance: 100V 50Hz 1Min
7. Service Life: 50,000 times

Circuit Diagram

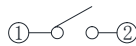

PCB Chart

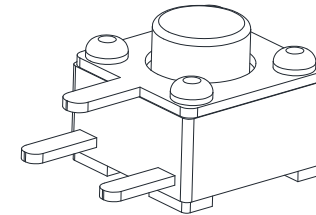
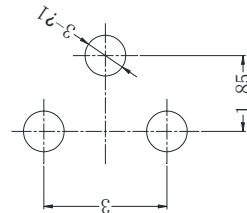

										First Perspective	Scale	Part No.	4.5x4.5XH 3 Pin
										1:1			
E	Cover	0.25 Iron Sheet	1	Copper plated tin						General Tolerance	Unit	Product Name	4.5x4.5 3 Pin Tactile Switch
D	Button	PPA Black	1	Purge						>0.5-2 ±0.1	mm		
C	Reed	Stainless steel overlay with silver	1		Marking Place	Change of document number	Signature	Date		>2-5 ±0.2			
B	Base	PPA Black	1	Purge						>5 ±0.3		Designed	Checked
A	Chuck	Brass 0.3	1	Silver-Plated						Angle ±1°		Approved	
S/N	List	Material	Quantity	Notes								Shenzhen Kinghelm Electronics Co., Ltd	www.kinghelm.net
												KH-4.5X4.5X4.3H-B3J	0755-28190160