

Rev	ECN Number	Description	Date	Drawn	Checked	Approved

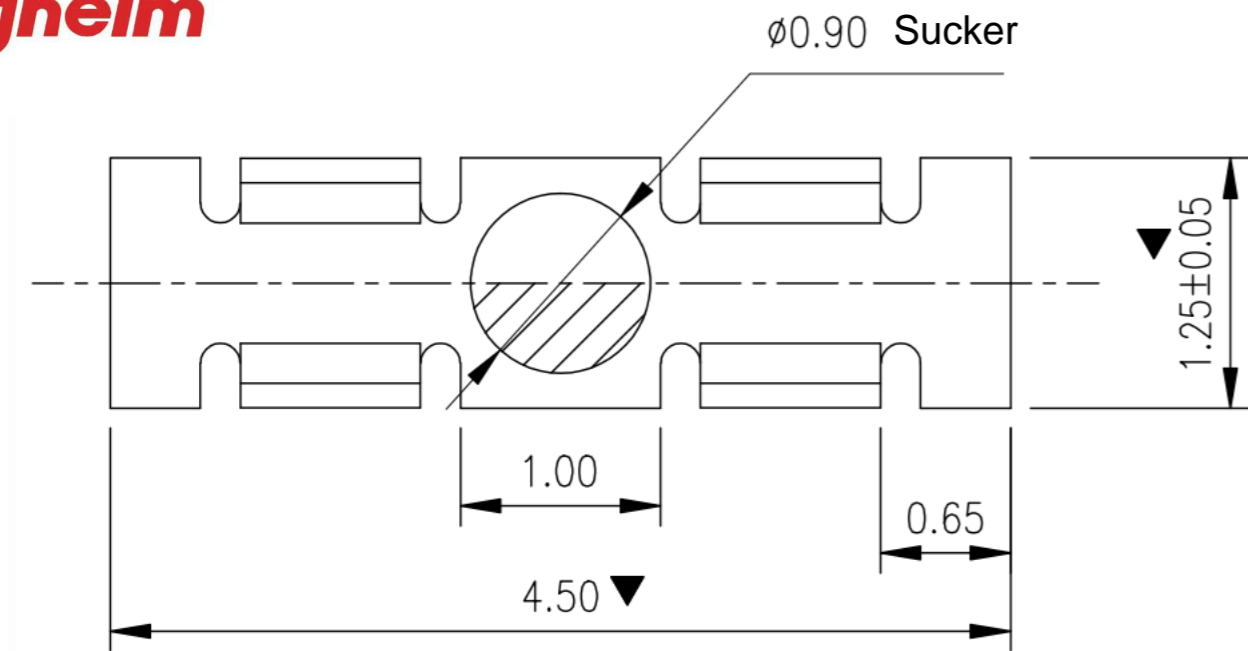

Technical Specification

1. Material: Stainless steel SUS301, $T=0.15 \pm 0.005$.
- ▼ 2. The soldering and contact surfaces of the terminal must be free from burrs, maximum burr size of 0.03mm allowed on other parts.
3. Torsion: 45° per 1000mm, Arch: 5mm per 1000mm.
4. Dimensions marked with ▼ are critical for control and inspection.
5. Unmarked R MAX R0.13.
6. The plating must pass a 24-hour salt spray test.
7. Life test > 20,000 cycles, product spring force requirement between 60gf to 80gf.
8. Nickel base 50-80 U" min; outer surface of the product is tinned around 80-100U" min.

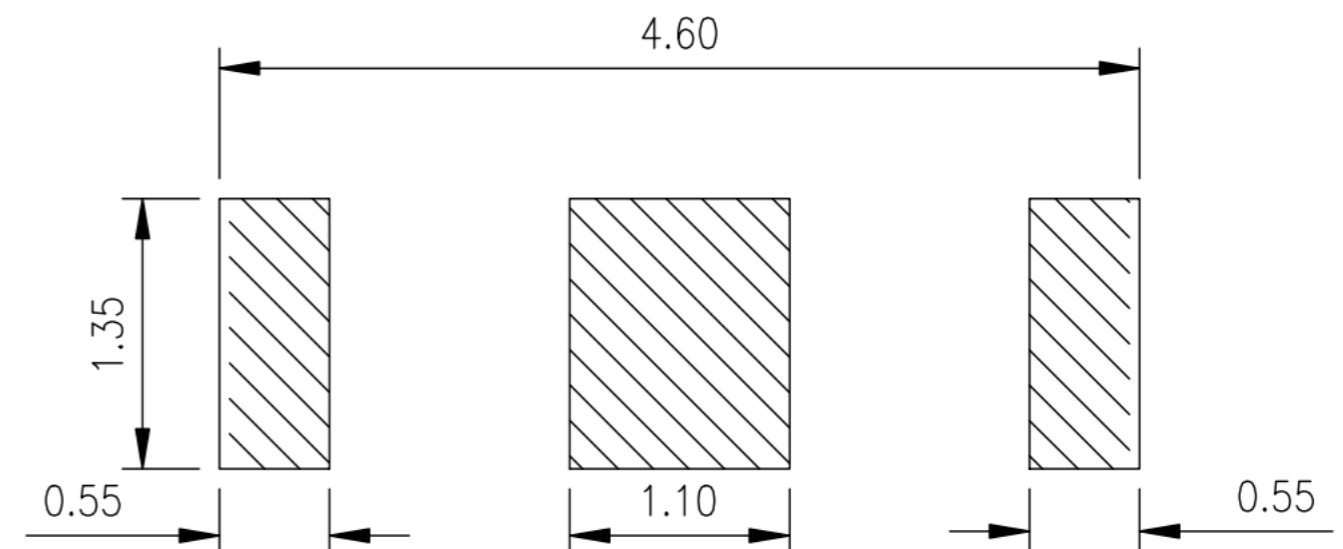
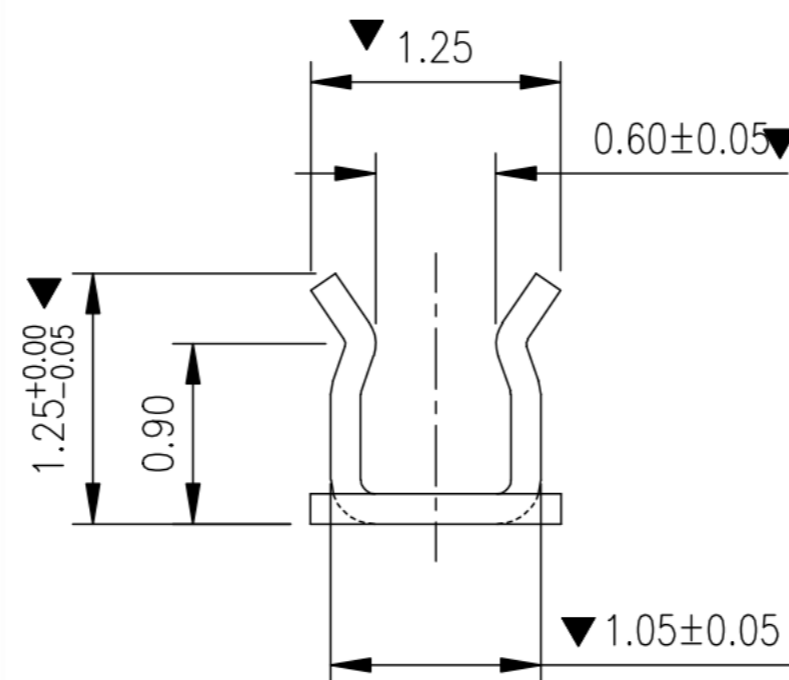
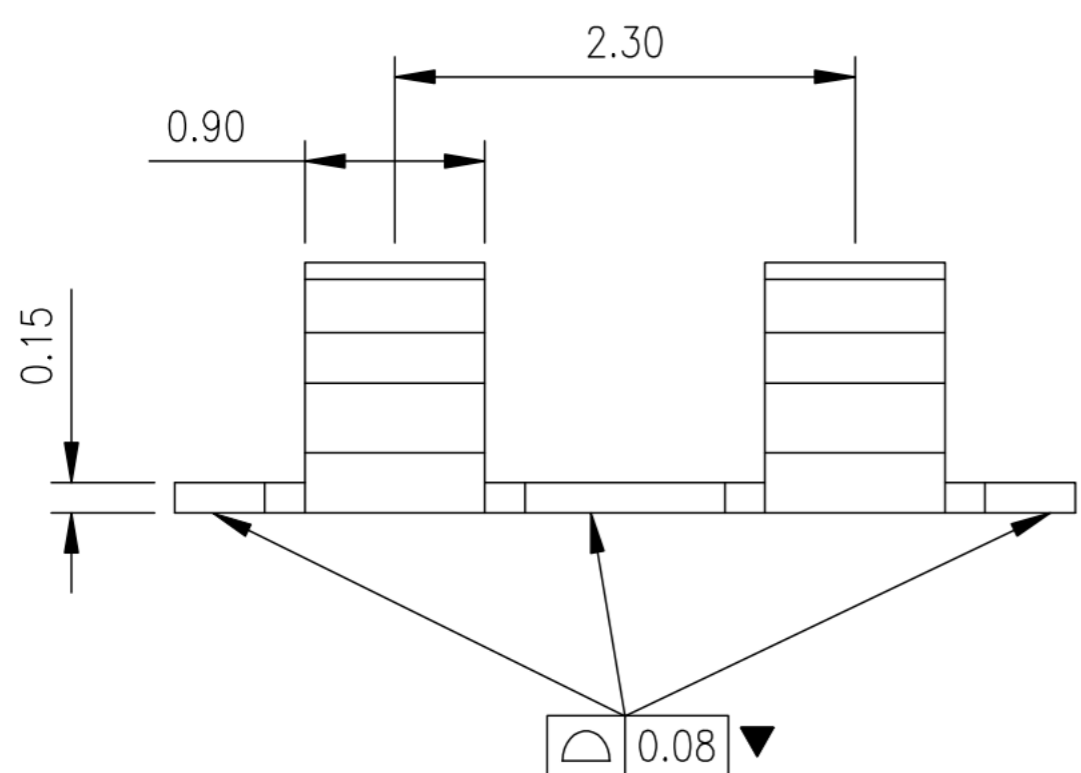

Welding Chassis Dimensions
Dimensional Tolerances ± 0.05

Diagram for Customer
RF Cable($\phi 0.81$) Can Clip
L4.5*W1.25*H1.25

General Tolerance	
XX. ± 0.35	
X. ± 0.35	X.° $\pm 2.0^\circ$
.X ± 0.25	.X° $\pm 1.0^\circ$
.XX ± 0.15	.XX° $\pm 0.5^\circ$

Scale: 1:1
Unit: mm
Size: A4

Drawn
Check
Approved
Date
Date
Date

DWG. No.
681-0074A-01
Parts No. (Intended Use)
0074A1

Shenzhen Kinghelm
Electronics Co.,Ltd
KH-PBJ-45125125

www.kinghelm.net
0755-28190160

REV.
A
Sheet
1/2