

Recommended P.C.B Layout (Top Side)

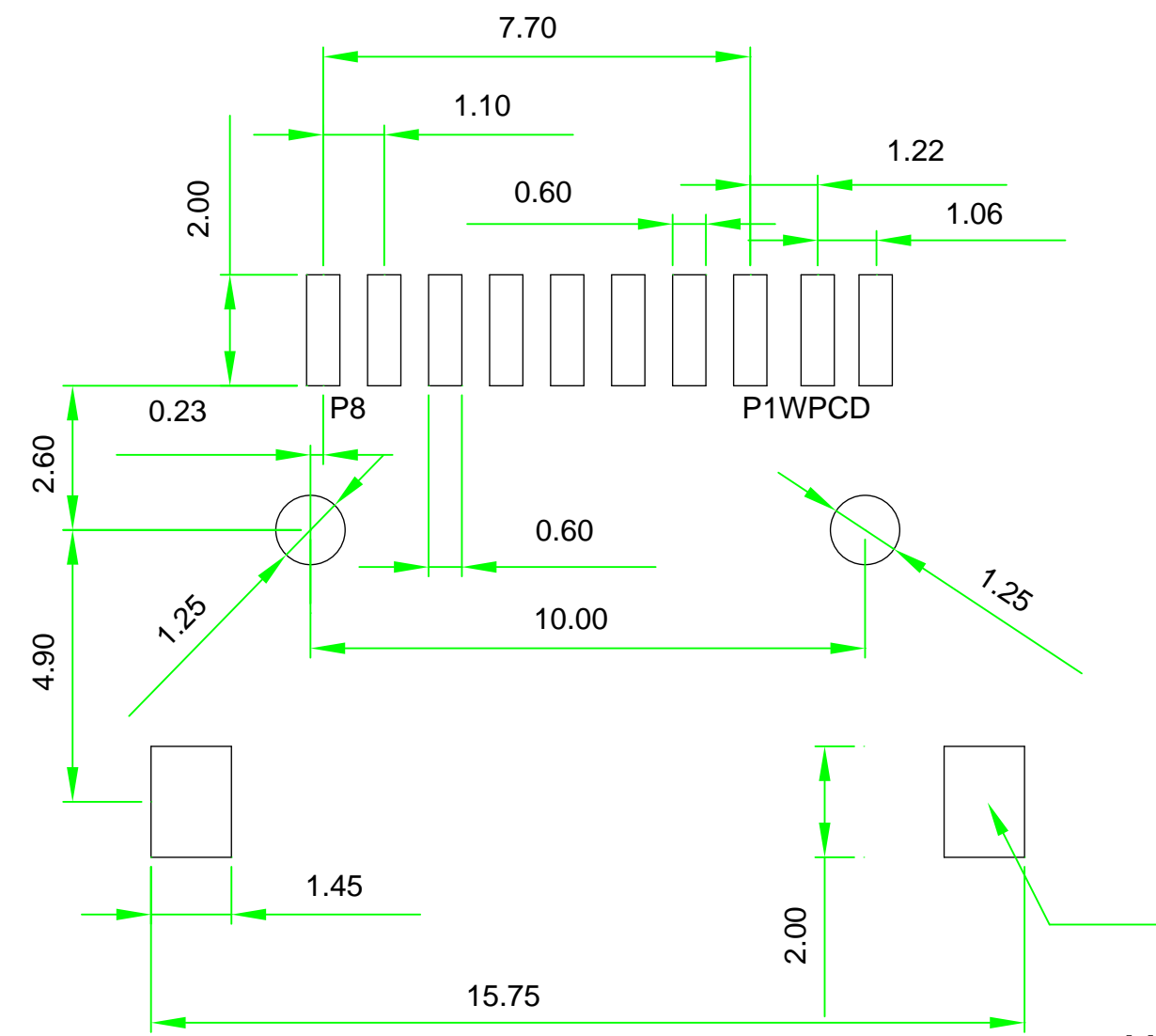

Notes:

1. Current Rating: 0.5A AC,DC
2. Temperature Range: - 40°C~+85°C
3. Contact Resistance: 40m max ☒
4. Insulation Resistance: 1000M min ☒
5. Withstanding Voltage: 500V AC/minute

Remark:

1. Terminals:
 - A. Shell: Brass/C2680-H
 - B. Terminal: H65-EH
 - C. Insulator: LCP, black color
2. Plating: The entire terminal is nickel-plated 50-80u", with a gold plating (brush plating) of 0.5u" minimum in the gold-plated area and a bright tin plating of 120u" minimum in the remaining parts
3. Maximum allowable burr size: 0.05mm
4. Appearance must be free from dents, dirt, mold marks, or any other defects
5. The size with "☒" mark is QIP inspection size
6. Dimensions with "XX" mark are FAI full inspection dimensions

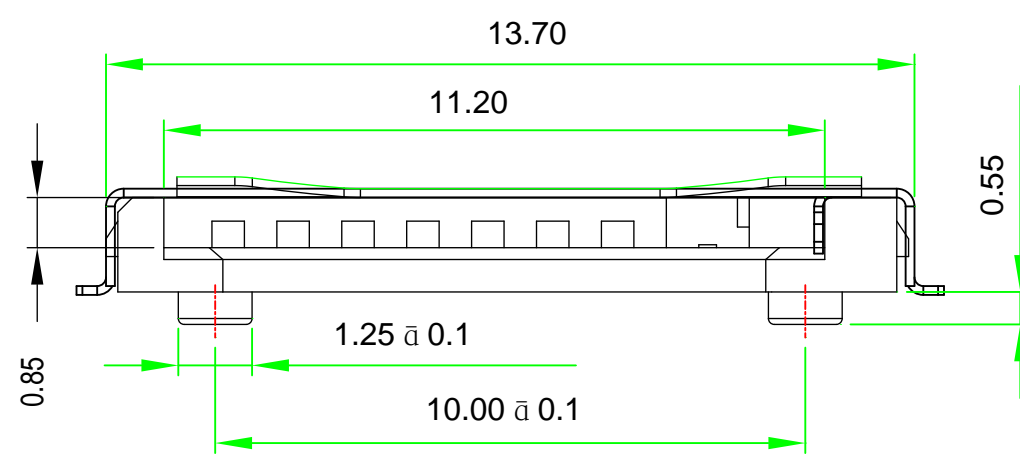

Pin No.	Pin Assignment
1#	DAT2
2#	CD/DAT3
3#	CMD
4#	VDD
5#	CLK
6#	VSS
7#	DAT0
8#	DAT1
9#	WP
10#	CD

Circuit

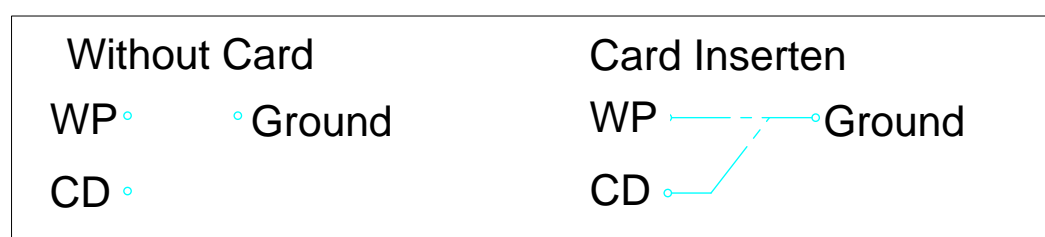

Operation		Design	Scale	1:1	Shenzhen Kinghelm Electronics Co., Ltd	www.kinghelm.net
0.00	±0.15					
0.0	±0.30	Check	Unit	mm	KH-TF016	0755-28190160
0	±0.40		Size	A4	Part No.	TF100-008SS3LBR001
Angle	± 3°	Approve	Sheet	1/1J	Title:	TF Simple Socket
DIM	TOL		PROJ.	Drawing No.		

Rev	Date	Modification Description	Change	Approve
A0	07/10/20	New		