

**Kinghelm®**

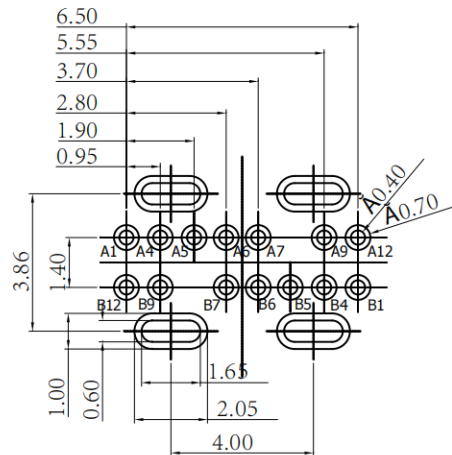
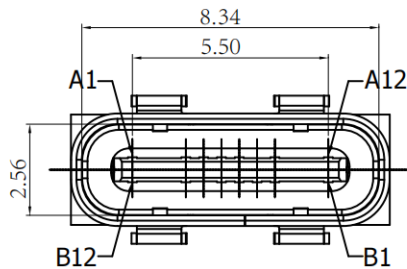
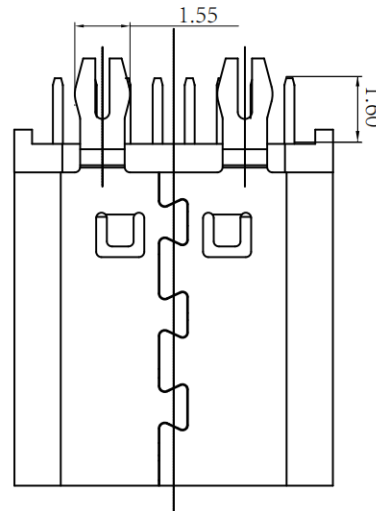
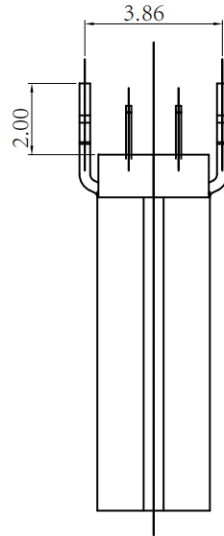
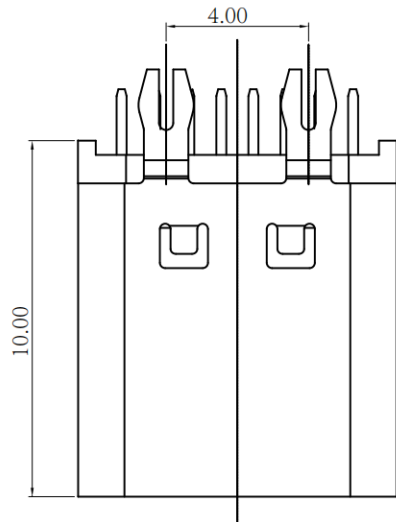
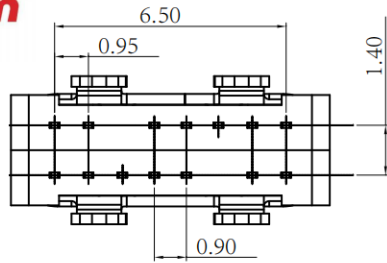

REV	DESCRIPTION	DATE	APPROVED
A/0	New Releases	2020.06.06	xiao

**Remarks**

1. Material:

- 1.1 Rubber core: LCP+30%G.F UL94V-0
- 1.2 Terminal: high conductivity copper, T=0.15mm; half gold bright tin 1μ"
- 1.3 Shell: SUS304, T=0.30mm; nickel plated 80μ" MIN
- 1.4 Sheet copper: SUS301, T=0.15mm

2. Main characteristics:

- 2.1 Rated current: 5.0A
- 2.2 Contact impedance: 40MILLTOHMS MAX
- 2.3 Insulation impedance: 150V DC/100 MEGA OHMS MIN
- 2.4 Withstanding voltage test: 100V AC/ 1MA MAX
- 2.5 Tinning: temperature 250±5°C, time 5±0.5s
- 2.6 Insertion force: 5~20N, pull-out force: 8~20N  
Service life: 10000 times, pull-out force: 5N MIN
- 2.7 Salt spray test: through 24H salt water salt spray no rust phenomenon
- 2.8 Working temperature: -30°C ~ +80°C

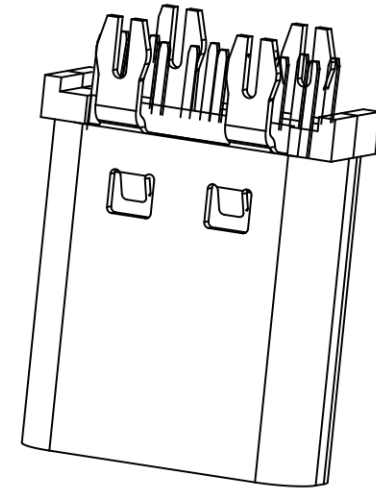

TOLERANCES		Shenzhen Kinghelm Electronics Co., Ltd	www.kinghelm.net	
.X	±0.30		KH-TYPE-C-L10-14P-2.0	0755-28190160
.XX	±0.20	APPROVED: TZ120 TITLE: TYPE-C 14P 180°Vertical L=10.0		
.XXX	±0.10	CHECKED: TZ101 PART NO.:		PROJECTION:
ANGLES	±2.00	DRAWING: TZ125 REV.: A/0 SIZE: A4 UNIT: M M SCALE: 1:1 SHEET: 1/1		