

**Kinghelm®**

ZONE	SYMBOL	REVISION	APPROVAL	DATE
A		INITIAL	JACK	20/06/06

SPECIFICATION :

- 1.CURRENT RATING:DC 0.5A MAX.
- 2: VOLTAGE RATING:DC 12V.
- 3: CONTACT RESISTANCE:50mΩ MAX.
- 4.INSULATION RESISTANCE:100MΩ MIN. AT 500V DC.
- 5.WITHSTANDING VOLTAGE:500V AC FOR 1 MINUTE.
- 6.LIFE TEST:5000 CYCLES MIN.
- 7.MATING FORCE: 3~30N,  
UNMATING FORCE: 3~30N.
- 8.TEPROOF LEVEL:IPX7

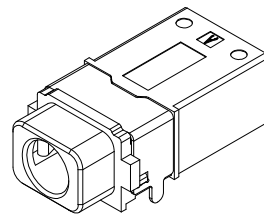
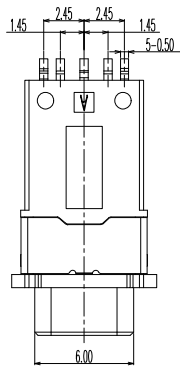
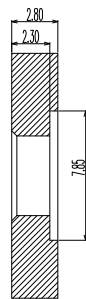
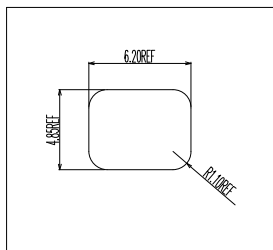

3D VIEW

面板开孔参考尺寸

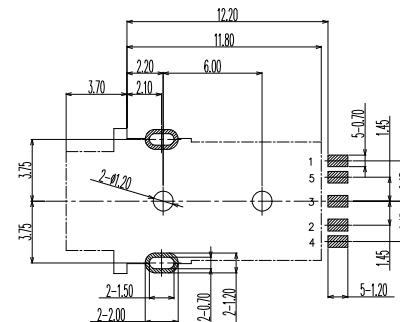
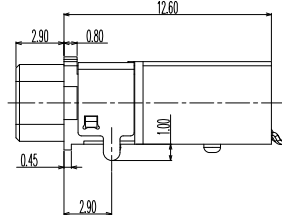
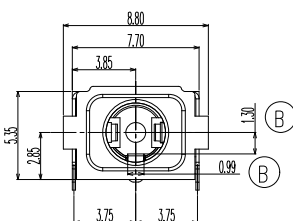
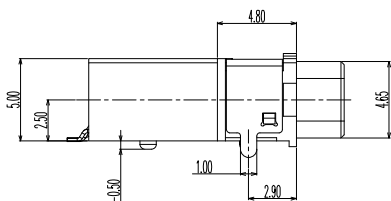

RECOMMENDED P.C.B. LAYOUT  
TOP VIEW

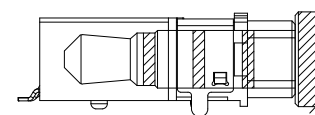
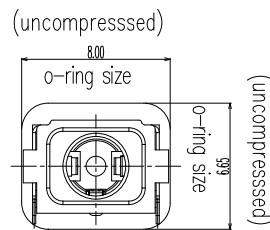
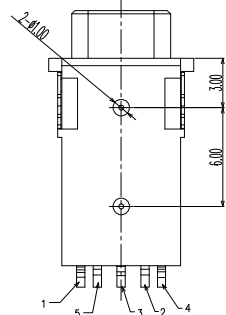
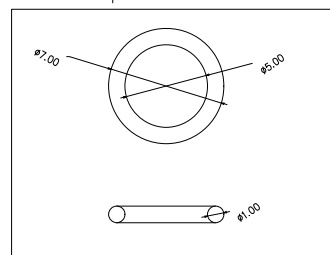

PLUG MATE DRAWING

SCHEMATIC(PLUG OUT)

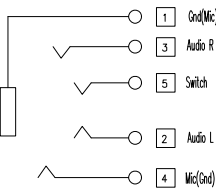

SCHEMATIC(PLUG IN)

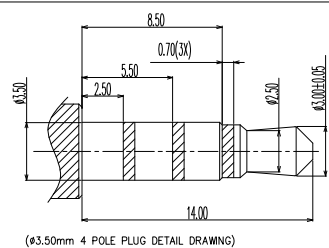
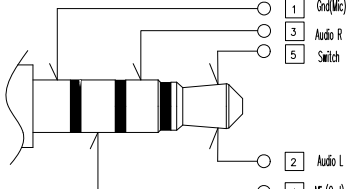

(Ø3.50mm 4 POLE PLUG DETAIL DRAWING)

ITEM	NAME	QTY	DESCRIPTION	NOTE
8	COVER	1	HIGH TEMPERATURE PLASTIC COLOR BLACK	
7	HOUSING	1	HIGH TEMPERATURE PLASTIC COLOR BLACK	
6	SHELL	1	PHOSPHOR BRONZE; THE BOTTOM OF THE NICKEL; THE WHOLE TIN PLATING	
5	TERMINAL 5#	1		
4	TERMINAL 4#	1	PHOSPHOR BRONZE; GOLD FLASH ON CONTACT AREA; GOLD FLASH PLATING ON SOLDER TAIL AREA, ALL OVER NICKEL PLATED	
3	TERMINAL 3#	1		
2	TERMINAL 2#	1	PHOSPHOR BRONZE; GOLD FLASH ON CONTACT AREA; GOLD FLASH PLATING ON SOLDER TAIL AREA, ALL OVER NICKEL PLATED	
1	TERMINAL 1#	1		

深圳市金航标电子有限公司

WWW.KINGHELM.COM.CN

0755-28190160

SHENZHEN KINGHELM ELECTRON CO.,LTD.

PART NAME 3.5mm STEREO JACK

TOLERANCE UNLESS 0.0±0.2  
OTHERWISE SPECIFIED: 0.00±0.1  
0.000±0.05

UNIT: mm



DRAWING:	W J Y	DATE:	2020.06.06	SCALE	5: 1
CHECK:	L Z G	DATE:	2020.06.06	MATERIAL	*
APPROVAL:	ZHENG	DATE:	2020.06.06	DWG. no.	A
DRAWING NO.	KH-PJ-23002-06SBAP-A		SHEET	1/1	

F

E

D

C

B

A DCF-04/A